

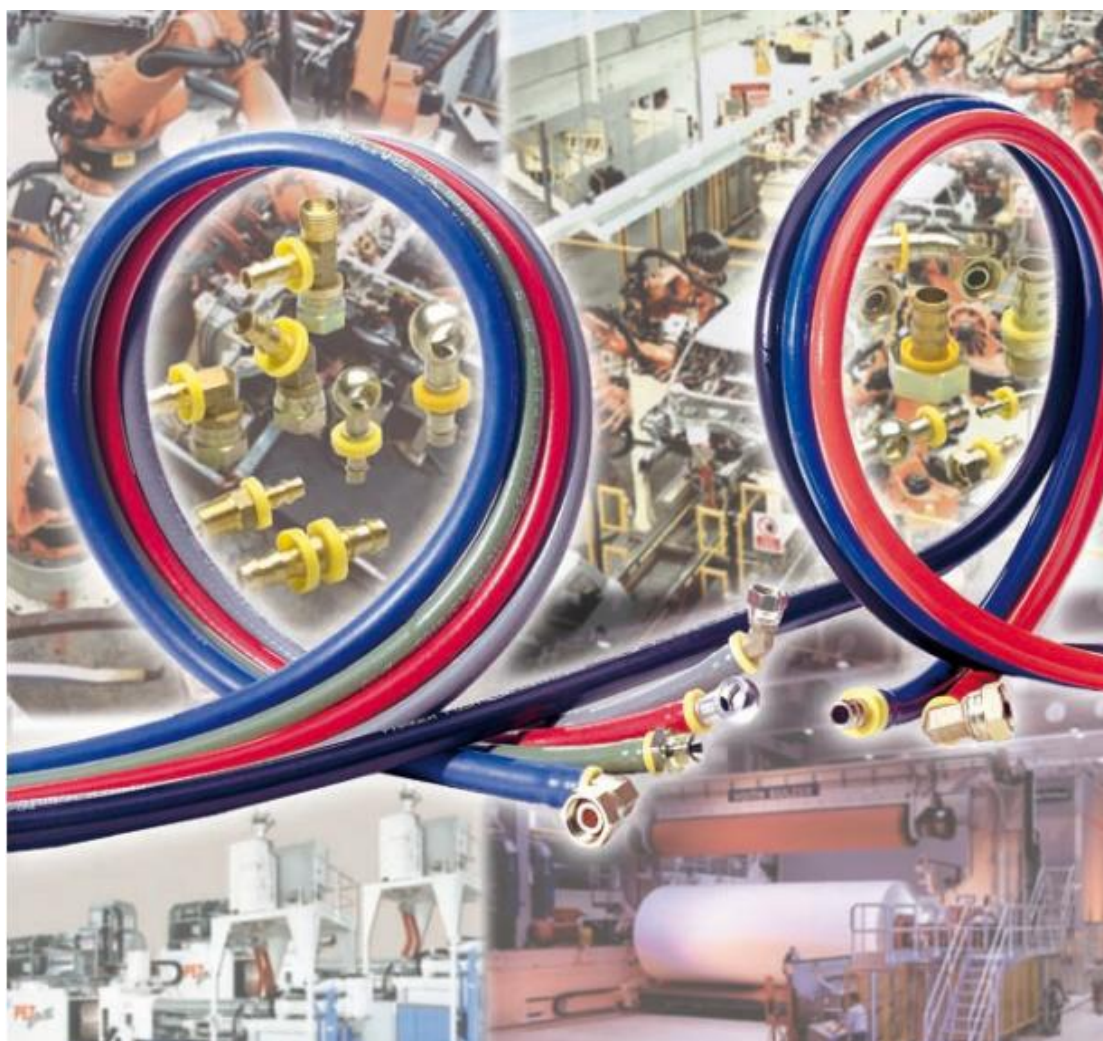

上海仰贡工程科技有限公司

铜接头及自锁软管接头系列

Brass & Push-Lok Fitting





PUSH-LOK接头的广泛应用



简单高效地管路设计

无需辅助工具安装

安全有效地管路连接

不同介质管路易于识别

广泛地化学兼容性

.....

使得Push-lok接头广泛地应用在汽车工业，造纸工业，自动化工业，电力设备等.....

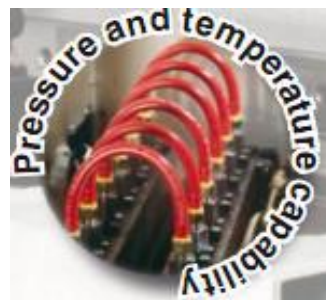



Push-lok Fittings

安装及拆卸示意



1. 用美工刀切割软管，尽量保证断面垂直。如需要可使用润滑剂（5%皂液+95%水）。



3. 沿轴线方向切开软管，切开角度约为 20° ，切开长度为1"，注意划伤接头齿部。



2. 将接头插入软管至第一齿，将接头顶住平面固定物，然后平稳地推动软管，直到软管一段被接头末黄圈覆盖住。



4. 握住软管接头从缺口种扒开即可。



高效，可靠的装配工具(型号PL001)

KG-PushLok铜制接头能安全可靠地连接上Parker, Legris, Goodyear等各品牌的水气多用途软管
如需重复使用接头，务必检查接头齿部是否有损伤，否则可能会导致泄漏！



3C382---公制60° 锥旋转螺母接头



型号	螺纹尺寸	接管尺寸
3C382-6-4B	M12X1.5	DN6-1/4"
3C382-8-4B	M14X1.5	DN6-1/4"
3C382-10-4B	M16X1.5	DN6-1/4"
3C382-10-6B	M16X1.5	DN10-3/8"
3C382-12-6B	M18X1.5	DN10-3/8"
3C382-15-8B	M22X1.5	DN12-1/2"
3C382-15-12B	M22X1.5	DN20-3/4"
3C382-22-12B	M30X2	DN20-3/4"
3C382-28-16B	M36X2	DN25-1"

3C482---公制60° 锥旋转螺母接头(45° 弯头)



型号	螺纹尺寸	接管尺寸
3C482-6-4B	M12X1.5	DN6-1/4"
3C482-8-4B	M14X1.5	DN6-1/4"
3C482-10-4B	M16X1.5	DN6-1/4"
3C482-10-6B	M16X1.5	DN10-3/8"
3C482-12-6B	M18X1.5	DN10-3/8"
3C482-15-8B	M22X1.5	DN12-1/2"
3C482-15-12B	M22X1.5	DN20-3/4"
3C482-22-12B	M30X2	DN20-3/4"

3C582---公制60° 锥旋转螺母接头(90° 弯头)



型号	螺纹尺寸	接管尺寸
3C582-6-4B	M12X1.5	DN6-1/4"
3C582-8-4B	M14X1.5	DN6-1/4"
3C582-10-4B	M16X1.5	DN6-1/4"
3C582-10-6B	M16X1.5	DN10-3/8"
3C582-12-6B	M18X1.5	DN10-3/8"
3C582-15-8B	M22X1.5	DN12-1/2"
3C582-15-12B	M22X1.5	DN20-3/4"
3C582-22-12B	M30X2	DN20-3/4"



3CA82--公制24° 锥旋转螺母接头(带O-Ring密封)



型号	螺纹尺寸	接管尺寸
3CA82-6-4B-OR	M12X1.5	DN6-1/4"
3CA82-8-4B-OR	M14X1.5	DN6-1/4"
3CA82-10-4B-OR	M16X1.5	DN6-1/4"
3CA82-10-6B-OR	M16X1.5	DN10-3/8"
3CA82-12-6B-OR	M18X1.5	DN10-3/8"
3CA82-15-8B-OR	M22X1.5	DN12-1/2"
3CA82-15-12B-OR	M22X1.5	DN20-3/4"
3CA82-22-12B-OR	M30X2	DN20-3/4"

3CE82--公制24° 锥旋转螺母接头(带O-Ring密封)(45° 弯头)



型号	螺纹尺寸	接管尺寸
3CE82-6-4B-OR	M12X1.5	DN6-1/4"
3CE82-8-4B-OR	M14X1.5	DN6-1/4"
3CE82-10-4B-OR	M16X1.5	DN6-1/4"
3CE82-10-6B-OR	M16X1.5	DN10-3/8"
3CE82-12-6B-OR	M18X1.5	DN10-3/8"
3CE82-15-8B-OR	M22X1.5	DN12-1/2"
3CE82-15-12B-OR	M22X1.5	DN20-3/4"
3CE82-22-12B-OR	M30X2	DN20-3/4"

3CF82--公制24° 锥旋转螺母接头(带O-Ring密封)(90° 弯头)



型号	螺纹尺寸	接管尺寸
3CF82-6-4B-OR	M12X1.5	DN6-1/4"
3CF82-8-4B-OR	M14X1.5	DN6-1/4"
3CF82-10-4B-OR	M16X1.5	DN6-1/4"
3CF82-10-6B-OR	M16X1.5	DN10-3/8"
3CF82-12-6B-OR	M18X1.5	DN10-3/8"
3CF82-15-8B-OR	M22X1.5	DN12-1/2"
3CF82-15-12B-OR	M22X1.5	DN20-3/4"
3CF82-22-12B-OR	M30X2	DN20-3/4"

3D082--公制24° 外螺纹接头



型号	螺纹尺寸	接管尺寸
3D082-6-4B-OR	M12X1.5	DN6-1/4"
3D082-8-4B-OR	M14X1.5	DN6-1/4"
3D082-10-4B-OR	M16X1.5	DN6-1/4"
3D082-10-6B-OR	M16X1.5	DN10-3/8"
3D082-12-6B-OR	M18X1.5	DN10-3/8"
3D082-15-8B-OR	M22X1.5	DN12-1/2"
3D082-15-12B-OR	M22X1.5	DN20-3/4"
3D082-22-12B-OR	M30X2	DN20-3/4"



3B382--英制60° 锥旋转螺母接头



型号	螺纹尺寸	接管尺寸
3B382-4-4B	G1/4"	DN6-1/4"
3B382-6-4B	G3/8"	DN6-1/4"
3B382-6-6B	G3/8"	DN10-3/8"
3B382-8-6B	G1/2"	DN10-3/8"
3B382-8-8B	G1/2"	DN12-1/2"
3B382-12-8B	G3/4"	DN12-1/2"
3B382-12-12B	G3/4"	DN20-3/4"
3B382-16-16B	G1"	DN25-1"

3B482--英制60° 锥旋转螺母接头 (45° 弯头)



型号	螺纹尺寸	接管尺寸
3B482-4-4B	G1/4"	DN6-1/4"
3B482-6-4B	G3/8"	DN6-1/4"
3B482-6-6B	G3/8"	DN10-3/8"
3B482-8-6B	G1/2"	DN10-3/8"
3B482-8-8B	G1/2"	DN12-1/2"
3B482-12-8B	G3/4"	DN12-1/2"
3B482-12-12B	G3/4"	DN20-3/4"

3B582--英制60° 锥旋转螺母接头 (90° 弯头)



型号	螺纹尺寸	接管尺寸
3B582-4-4B	G1/4"	DN6-1/4"
3B582-6-4B	G3/8"	DN6-1/4"
3B582-6-6B	G3/8"	DN10-3/8"
3B582-8-6B	G1/2"	DN10-3/8"
3B582-8-8B	G1/2"	DN12-1/2"
3B582-12-8B	G3/4"	DN12-1/2"
3B582-12-12B	G3/4"	DN20-3/4"

VW121-德标英制接头



型号	螺纹尺寸	接管尺寸
VW121-8937	G1/4"	DN6-1/4"
VW121-8938	G3/8"	DN10-3/8"
VW121-8939	G1/2"	DN12-1/2"
VW121-8940	G3/4"	DN16-5/8"
VW121-8941	G1"	DN20-3/4"



3B182--英制外螺纹 (BSPT) 接头



型号	螺纹尺寸	接管尺寸
3B182-4-4B	G1/4"	DN6-1/4"
3B182-6-4B	G3/8"	DN6-1/4"
3B182-6-6B	G3/8"	DN10-3/8"
3B182-8-6B	G1/2"	DN10-3/8"
3B182-8-8B	G1/2"	DN12-1/2"
3B182-12-8B	G3/4"	DN12-1/2"
3B182-12-12B	G3/4"	DN20-3/4"

3B282WD--英制外螺纹 (BSPP) 接头带WD垫密封



型号	螺纹尺寸	接管尺寸
3B282-4-4B-WD	G1/4"	DN6-1/4"
3B282-6-4B-WD	G3/8"	DN6-1/4"
3B282-6-6B-WD	G3/8"	DN10-3/8"
3B282-8-6B-WD	G1/2"	DN10-3/8"
3B282-8-8B-WD	G1/2"	DN12-1/2"
3B282-12-8B-WD	G3/4"	DN12-1/2"
3B282-12-12B-WD	G3/4"	DN20-3/4"

3B282--英制外螺纹 (BSPP) 接头



型号	螺纹尺寸	接管尺寸
3B282-4-4B	G1/4"	DN6-1/4"
3B282-6-4B	G3/8"	DN6-1/4"
3B282-6-6B	G3/8"	DN10-3/8"
3B282-8-6B	G1/2"	DN10-3/8"
3B282-8-8B	G1/2"	DN12-1/2"
3B282-12-8B	G3/4"	DN12-1/2"
3B282-12-12B	G3/4"	DN20-3/4"

3BB82--英制外螺纹 (BSPT) 可旋转接头



型号	螺纹尺寸	接管尺寸
3BB82-4-4B	G1/4"	DN6-1/4"
3BB82-6-6B	G3/8"	DN6-1/4"
3BB82-8-8B	G3/8"	DN10-3/8"
3BB82-12-12B	G1/2"	DN10-3/8"



30682--美制37° 凹口旋转螺母接头



型号	螺纹尺寸	接管尺寸
30682-4-4B	7/16"-20	DN6-1/4"
30682-6-4B	9/16"-18	DN6-1/4"
30682-6-6B	9/16"-18	DN10-3/8"
30682-8-6B	3/4"-16	DN10-3/8"
30682-8-8B	3/4"-16	DN12-1/2"
30682-12-8B	1-1/16"-12	DN12-1/2"
30682-12-12B	1-1/16"-12	DN20-3/4"

30982--美制37° 凹口旋转螺母接头 (90° 弯头)



型号	螺纹尺寸	接管尺寸
30982-4-4B	7/16"-20	DN6-1/4"
30982-6-4B	9/16"-18	DN6-1/4"
30982-6-6B	9/16"-18	DN10-3/8"
30982-8-6B	3/4"-16	DN10-3/8"
30982-8-8B	3/4"-16	DN12-1/2"
30982-12-8B	1-1/16"-12	DN12-1/2"
30982-12-12B	1-1/16"-12	DN20-3/4"

30182--美制NPT外螺纹接头



型号	螺纹尺寸	接管尺寸
30182-4-4B	NPT1/4"x18	DN6-1/4"
30182-6-4B	NPT3/8"x18	DN6-1/4"
30182-6-6B	NPT3/8"x18	DN10-3/8"
30182-8-6B	NPT1/2"x14	DN10-3/8"
30182-8-8B	NPT1/2"x14	DN12-1/2"
30182-12-8B	NPT3/4"x14	DN12-1/2"
30182-12-12B	NPT3/4"x14	DN20-3/4"

30282--美制NPT内螺纹接头



型号	螺纹尺寸	接管尺寸
30282-4-4B	NPT1/4"x18	DN6-1/4"
30282-6-4B	NPT3/8"x18	DN6-1/4"
30282-6-6B	NPT3/8"x18	DN10-3/8"
30282-8-6B	NPT1/2"x14	DN10-3/8"
30282-8-8B	NPT1/2"x14	DN12-1/2"
30282-12-8B	NPT3/4"x14	DN12-1/2"
30282-12-12B	NPT3/4"x14	DN20-3/4"



30382--美制JIC37° 外螺纹接头



型号	螺纹尺寸	接管尺寸
30382-4-4B	7/16"-20	DN6-1/4"
30382-6-4B	9/16"-18	DN6-1/4"
30382-6-6B	9/16"-18	DN10-3/8"
30382-8-6B	3/4"-16	DN10-3/8"
30382-8-8B	3/4"-16	DN12-1/2"
30382-12-8B	1-1/16"-12	DN12-1/2"
30382-12-12B	1-1/16"-12	DN20-3/4"

30082--美制ORFS平面旋转螺母接头



型号	螺纹尺寸	接管尺寸
30082-4-4B	UNF9/16"-18	DN6-1/4"
30082-6-4B	UNF11/16"-16	DN6-1/4"
30082-6-6B	UNF11/16"-16	DN10-3/8"
30082-8-6B	UNF13/16"-16	DN10-3/8"
30082-8-8B	UNF13/16"-16	DN12-1/2"
30082-12-8B	UNF1-3/16"-12	DN12-1/2"
30082-12-12B	UNF1-3/16"-12	DN20-3/4"

33482--光杆卡套连接接头



型号	光杆尺寸	接管尺寸
33482-6-4B	φ6	DN6-1/4"
33482-8-4B	φ8	DN6-1/4"
33482-10-6B	φ10	DN10-3/8"
33482-12-6B	φ12	DN10-3/8"
33482-15-8B	φ15	DN12-1/2"
33482-22-12B	φ22	DN20-3/4"

38282--对接接头



型号	接管尺寸	接管尺寸
38282-4-4B	DN6-1/4"	DN6-1/4"
38282-6-6B	DN10-3/8"	DN10-3/8"
38282-8-8B	DN12-1/2"	DN12-1/2"
38282-12-12B	DN20-3/4"	DN20-3/4"
38282-16-16B	DN25-1"	DN25-1"



3YW82--镀镍快插接头



型号	接管尺寸	接管尺寸
3YW82-6-4B	φ6	DN6-1/4"
3YW82-8-4B	φ8	DN6-1/4"
3YW82-10-6B	φ10	DN10-3/8"
3YW82-12-8B	φ12	DN12-1/2"

3DP82--公制螺纹三通连接接头



型号	螺纹尺寸	接管尺寸
3DP82-6-6-4B	M12X1.5	DN6-1/4"
3DP82-8-8-4B	M14X1.5	DN6-1/4"
3DP82-10-10-6B	M16X1.5	DN10-3/8"
3DP82-15-15-8B	M22X1.5	DN12-1/2"

3DR82--公制螺纹三通连接接头



型号	螺纹尺寸	接管尺寸
3DR82-6-6-4B	M12X1.5	DN6-1/4"
3DR82-8-8-4B	M14X1.5	DN6-1/4"
3DR82-10-10-6B	M16X1.5	DN10-3/8"
3DR82-15-15-8B	M22X1.5	DN12-1/2"

3BP82--英制螺纹三通连接接头



型号	螺纹尺寸	接管尺寸
3BP82-4-4-4B	G1/4"	DN6-1/4"
3BP82-6-6-6B	G3/8"	DN10-3/8"
3BP82-8-8-8B	G1/2"	DN12-1/2"

3BR82--英制螺纹三通连接接头



型号	螺纹尺寸	接管尺寸
3BR82-4-4-4B	G1/4"	DN6-1/4"
3BR82-6-6-6B	G3/8"	DN10-3/8"
3BR82-8-8-8B	G1/2"	DN12-1/2"



EG--公制60° 锥口接管/英制锥螺纹BSPT接口接头

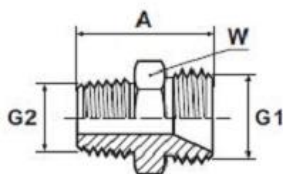

型号	接管螺纹1	接口螺纹2
EG06-1/8B	M12X1.5	R1/8"
EG06-1/4B	M12X1.5	R1/4"
EG08-1/4B	M14X1.5	R1/4"
EG08-3/8B	M14X1.5	R3/8"
EG10-1/4B	M16X1.5	R1/4"
EG10-3/8B	M16X1.5	R3/8"
EG12-1/4B	M18X1.5	R1/4"
EG12-3/8B	M18X1.5	R3/8"
EG15-3/8B	M22X1.5	R3/8"
EG15-1/2B	M22X1.5	R1/2"
EG22-1/2B	M30X2	R1/2"
EG22-3/4B	M30X2	R3/4"

EV--公制60° 锥口接管/英制锥螺纹BSPT接口接头(45° 弯头)

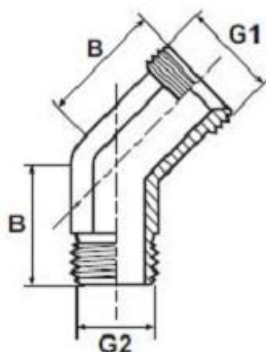

型号	接管螺纹1	接口螺纹2
EV06-1/8B	M12X1.5	R1/8"
EV06-1/4B	M12X1.5	R1/4"
EV08-1/4B	M14X1.5	R1/4"
EV08-3/8B	M14X1.5	R3/8"
EV10-1/4B	M16X1.5	R1/4"
EV10-3/8B	M16X1.5	R3/8"
EV12-1/4B	M18X1.5	R1/4"
EV12-3/8B	M18X1.5	R3/8"
EV15-3/8B	M22X1.5	R3/8"
EV15-1/2B	M22X1.5	R1/2"
EV22-1/2B	M30X2	R1/2"
EV22-3/4B	M30X2	R3/4"

EW--公制60° 锥口接管/英制锥螺纹BSPT接口接头(90° 弯头)

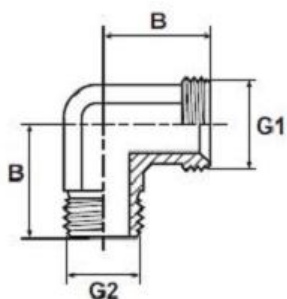

型号	接管螺纹1	接口螺纹2
EW06-1/8B	M12X1.5	R1/8"
EW06-1/4B	M12X1.5	R1/4"
EW08-1/4B	M14X1.5	R1/4"
EW08-3/8B	M14X1.5	R3/8"
EW10-1/4B	M16X1.5	R1/4"
EW10-3/8B	M16X1.5	R3/8"
EW12-1/4B	M18X1.5	R1/4"
EW12-3/8B	M18X1.5	R3/8"
EW15-3/8B	M22X1.5	R3/8"
EW15-1/2B	M22X1.5	R1/2"
EW22-1/2B	M30X2	R1/2"
EW22-3/4B	M30X2	R3/4"



BG--英制60° 锥口接管/英制锥螺纹BSPT锥口接口接头

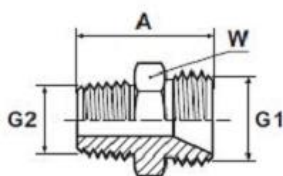

型号	接管螺纹1	接口螺纹2
BG-04-1/8B	G1/4"	R1/8"
BG-04-1/4B	G1/4"	R1/4"
BG-04-3/8B	G1/4"	R3/8"
BG-06-1/4B	G3/8"	R1/4"
BG-06-3/8B	G3/8"	R3/8"
BG-06-1/2B	G3/8"	R1/2"
BG-08-1/4B	G1/2"	R1/4"
BG-08-3/8B	G1/2"	R3/8"
BG-08-1/2B	G1/2"	R1/2"
BG-08-3/4B	G1/2"	R3/4"
BG-12-1/2B	G3/4"	R1/2"
BG-12-3/4B	G3/4"	R3/4"

BV--英制60° 锥口接管/英制锥螺纹BSPT接口接头(45° 弯头)

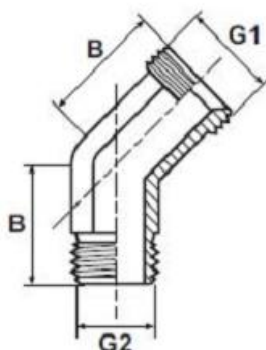

型号	接管螺纹1	接口螺纹2
BV-04-1/8B	G1/4"	R1/8"
BV-04-1/4B	G1/4"	R1/4"
BV-06-1/4B	G3/8"	R1/4"
BV-06-3/8B	G3/8"	R3/8"
BV-08-1/4B	G1/2"	R1/4"
BV-08-3/8B	G1/2"	R3/8"
BV-08-1/2B	G1/2"	R1/2"
BV-12-1/2B	G3/4"	R1/2"
BV-12-3/4B	G3/4"	R3/4"

BW--英制60° 锥口接管/英制锥螺纹BSPT接口接头(90° 弯头)

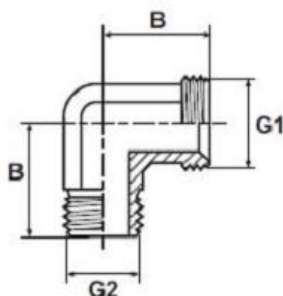

型号	接管螺纹1	接口螺纹2
BW-04-1/8B	G1/4"	R1/8"
BW-04-1/4B	G1/4"	R1/4"
BW-06-1/4B	G3/8"	R1/4"
BW-06-3/8B	G3/8"	R3/8"
BW-08-1/4B	G1/2"	R1/4"
BW-08-3/8B	G1/2"	R3/8"
BW-08-1/2B	G1/2"	R1/2"
BW-12-1/2B	G3/4"	R1/2"
BW-12-3/4B	G3/4"	R3/4"



JG--美制JIC37° 锥口接管/英制锥螺纹BPST接口接头

JN--美制JIC37° 锥口接管/美制锥螺纹NPT接口接头

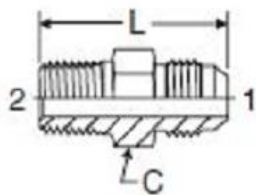

型号	接管螺纹1	接口螺纹2
JG-04-1/8B	JIC7/16"	R1/8"
JG-04-1/4B	JIC7/16"	R1/4"
JG-04-3/8B	JIC7/16"	R3/8"
JG-06-1/8B	JIC9/16"	R1/8"
JG-06-1/4B	JIC9/16"	R1/4"
JG-06-3/8B	JIC9/16"	R3/8"
JG-06-1/2B	JIC9/16"	R1/2"
JG-08-1/4B	JIC3/4"	R1/4"
JG-08-3/8B	JIC3/4"	R3/8"
JG-08-1/2B	JIC3/4"	R1/2"
JG-08-3/4B	JIC3/4"	R3/4"
JG-12-1/2B	JIC1-1/16"	R1/2"
JG-12-3/4B	JIC1-1/16"	R3/4"
JG-12-1B	JIC1-1/16"	R1"
JN-04-1/8B	JIC7/16"	NPT1/8"
JN-04-1/4B	JIC7/16"	NPT1/4"
JN-04-3/8B	JIC7/16"	NPT3/8"
JN-06-1/8B	JIC9/16"	NPT1/8"
JN-06-1/4B	JIC9/16"	NPT1/4"
JN-06-3/8B	JIC9/16"	NPT3/8"
JN-06-1/2B	JIC9/16"	NPT1/2"
JN-08-1/4B	JIC3/4"	NPT1/4"
JN-08-3/8B	JIC3/4"	NPT3/8"
JN-08-1/2B	JIC3/4"	NPT1/2"
JN-08-3/4B	JIC3/4"	NPT3/4"
JN-12-1/2B	JIC1-1/16"	NPT1/2"
JN-12-3/4B	JIC1-1/16"	NPT3/4"
JN-12-1B	JIC1-1/16"	NPT1"



JGV--美制JIC37° 锥口接管/英制锥螺纹BPST接口接头(45° 弯头)

JNV--美制JIC37° 锥口接管/美制锥螺纹NPT接口接头(45° 弯头)

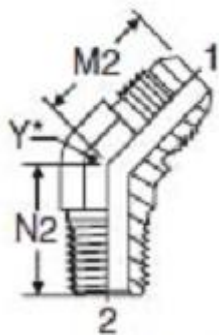

型号	接管螺纹1	接口螺纹2
JGV-04-1/8B	JIC7/16"	R1/8"
JGV-04-1/4B	JIC7/16"	R1/4"
JGV-06-1/8B	JIC9/16"	R1/8"
JGV-06-1/4B	JIC9/16"	R1/4"
JGV-06-3/8B	JIC9/16"	R3/8"
JGV-08-1/4B	JIC3/4"	R1/4"
JGV-08-3/8B	JIC3/4"	R3/8"
JGV-08-1/2B	JIC3/4"	R1/2"
JGV-12-1/2B	JIC1-1/16"	R1/2"
JGV-12-3/4B	JIC1-1/16"	R3/4"
JNV-04-1/8B	JIC7/16"	NPT1/8"
JNV-04-1/4B	JIC7/16"	NPT1/4"
JNV-06-1/8B	JIC9/16"	NPT1/8"
JNV-06-1/4B	JIC9/16"	NPT1/4"
JNV-06-3/8B	JIC9/16"	NPT3/8"
JNV-08-1/4B	JIC3/4"	NPT1/4"
JNV-08-3/8B	JIC3/4"	NPT3/8"
JNV-08-1/2B	JIC3/4"	NPT1/2"
JNV-12-1/2B	JIC1-1/16"	NPT1/2"
JNV-12-3/4B	JIC1-1/16"	NPT3/4"

JGW--美制JIC37° 锥口接管/英制锥螺纹BPST接口接头(90° 弯头)

JNV--美制JIC37° 锥口接管/美制锥螺纹NPT接口接头(45° 弯头)

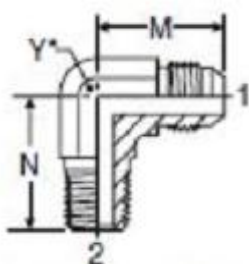

型号	接管螺纹1	接口螺纹2
JGW-04-1/8B	JIC7/16"	R1/8"
JGW-04-1/4B	JIC7/16"	R1/4"
JGW-06-1/8B	JIC9/16"	R1/8"
JGW-06-1/4B	JIC9/16"	R1/4"
JGW-06-3/8B	JIC9/16"	R3/8"
JGW-08-1/4B	JIC3/4"	R1/4"
JGW-08-3/8B	JIC3/4"	R3/8"
JGW-08-1/2B	JIC3/4"	R1/2"
JGW-12-1/2B	JIC1-1/16"	R1/2"
JGW-12-3/4B	JIC1-1/16"	R3/4"
JNV-04-1/8B	JIC7/16"	NPT1/8"
JNV-04-1/4B	JIC7/16"	NPT1/4"
JNV-06-1/8B	JIC9/16"	NPT1/8"
JNV-06-1/4B	JIC9/16"	NPT1/4"
JNV-06-3/8B	JIC9/16"	NPT3/8"
JNV-08-1/4B	JIC3/4"	NPT1/4"
JNV-08-3/8B	JIC3/4"	NPT3/8"
JNV-08-1/2B	JIC3/4"	NPT1/2"
JNV-12-1/2B	JIC1-1/16"	NPT1/2"
JNV-12-3/4B	JIC1-1/16"	NPT3/4"



CR--公制24° 锥口接管/英制锥螺纹BSPT接口接头

CN--公制24° 锥口接管/美制锥螺纹NPT接口接头

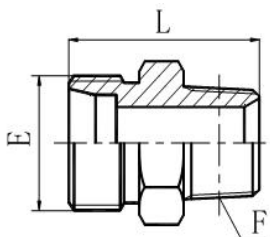

型号	接管螺纹1	接口螺纹2
CR06-1/8B	M12X1.5	R1/8"
CR06-1/4B	M12X1.5	R1/4"
CR08-1/8B	M14X1.5	R1/8"
CR08-1/4B	M14X1.5	R1/4"
CR10-1/4B	M16X1.5	R1/4"
CR10-3/8B	M16X1.5	R3/8"
CR10-1/2B	M16X1.5	R1/2"
CR12-1/4B	M18X1.5	R1/4"
CR12-3/8B	M18X1.5	R3/8"
CR12-1/2B	M18X1.5	R1/2"
CR15-3/8B	M22X1.5	R3/8"
CR15-1/2B	M22X1.5	R1/2"
CR15-3/4B	M22X1.5	R3/4"
CR22-1/2B	M30X2	R1/2"
CR22-3/4B	M30X2	R3/4"
CR28-3/4B	M36X2	R3/4"
CR28-1B	M36X2	R1"
CN06-1/8B	M12X1.5	NPT1/8"
CN06-1/4B	M12X1.5	NPT1/4"
CN08-1/8B	M14X1.5	NPT1/8"
CN08-1/4B	M14X1.5	NPT1/4"
CN10-1/4B	M16X1.5	NPT1/4"
CN10-3/8B	M16X1.5	NPT3/8"
CN10-1/2B	M16X1.5	NPT1/2"
CN12-1/4B	M18X1.5	NPT1/4"
CN12-3/8B	M18X1.5	NPT3/8"
CN12-1/2B	M18X1.5	NPT1/2"
CN15-3/8B	M22X1.5	NPT3/8"
CN15-1/2B	M22X1.5	NPT1/2"
CN15-3/4B	M22X1.5	NPT3/4"
CN22-1/2B	M30X2	NPT1/2"
CN22-3/4B	M30X2	NPT3/4"
CN28-3/4B	M36X2	NPT3/4"
CN28-1B	M36X2	NPT1"



CG/ED--公制24° 锥口接管/英制管螺纹BSPP接口接头(带ED胶垫密封)

CM/ED--公制24° 锥口接管/公制管螺纹M接口接头(带ED胶垫密封)

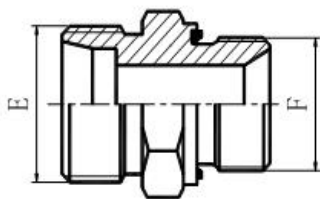

型号	接管螺纹1	接口螺纹2
CG06-1/8B-ED	M12X1.5	G1/8"
CG06-1/4B-ED	M12X1.5	G1/4"
CG08-1/8B-ED	M14X1.5	G1/8"
CG08-1/4B-ED	M14X1.5	G1/4"
CG10-1/4B-ED	M16X1.5	G1/4"
CG10-3/8B-ED	M16X1.5	G3/8"
CG10-1/2B-ED	M16X1.5	G1/2"
CG12-1/4B-ED	M18X1.5	G1/4"
CG12-3/8B-ED	M18X1.5	G3/8"
CG12-1/2B-ED	M18X1.5	G1/2"
CG15-3/8B-ED	M22X1.5	G3/8"
CG15-1/2B-ED	M22X1.5	G1/2"
CG15-3/4B-ED	M22X1.5	G3/4"
CG22-1/2B-ED	M30X2	G1/2"
CG22-3/4B-ED	M30X2	G3/4"
CG28-3/4B-ED	M36X2	G3/4"
CG28-1B-ED	M36X2	G1"
CM06-10B-ED	M12X1.5	M10X1
CM08-12B-ED	M14X1.5	M12X1.5
CM10-14B-ED	M16X1.5	M14X1.5
CM10-16B-ED	M16X1.5	M16X1.5
CM12-16B-ED	M18X1.5	M16X1.5
CM12-18B-ED	M18X1.5	M18X1.5
CM12-22B-ED	M18X1.5	M22X1.5
CM15-18B-ED	M22X1.5	M18X1.5
CM15-22B-ED	M22X1.5	M22X1.5
CM22-26B-ED	M30X2	M26X1.5
CM28-33B-ED	M36X2	M33X2

CRW--公制24° 锥口接管/英制锥螺纹BSPT接口接头(90° 弯头)

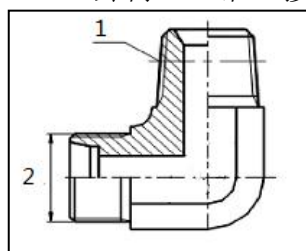

型号	接管螺纹1	接口螺纹2
CRW-06-1/8B	M12X1.5	R1/8"
CRW-06-1/4B	M12X1.5	R1/4"
CRW-08-1/4B	M14X1.5	R1/4"
CRW-10-1/4B	M14X1.5	R1/4"
CRW-10-3/8B	M16X1.5	R3/8"
CRW-12-1/4B	M16X1.5	R1/4"
CRW-12-3/8B	M16X1.5	R3/8"
CRW-15-3/8B	M18X1.5	R3/8"
CRW-15-1/2B	M18X1.5	R1/2"
CRW-22-1/2B	M18X1.5	R1/2"
CRW-22-3/4B	M22X1.5	R3/4"



CC--公制24° 锥口接管对接接头

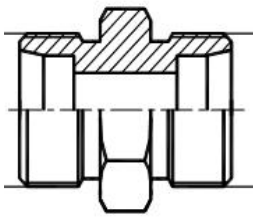

型号	接管螺纹1	接管螺纹2
CC-06-06B	M12X1.5	M12X1.5
CC-08-08B	M14X1.5	M14X1.5
CC-08-06B	M14X1.5	M12X1.5
CC-10-10B	M16X1.5	M16X1.5
CC-10-08B	M16X1.5	M14X1.5
CC-12-12B	M18X1.5	M18X1.5
CC-12-08B	M18X1.5	M14X1.5
CC-12-10B	M18X1.5	M16X1.5
CC-15-15B	M22X1.5	M22X1.5
CC-15-10B	M22X1.5	M16X1.5
CC-15-12B	M22X1.5	M18X1.5
CC-22-22B	M30X2	M30X2
CC-22-15B	M30X2	M22X1.5

CW--公制24° 锥口接管对接接头(90° 弯头)

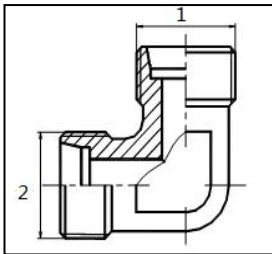

型号	接管螺纹1	接管螺纹2
CW-06-06B	M12X1.5	M12X1.5
CW-08-08B	M14X1.5	M14X1.5
CW-08-06B	M14X1.5	M12X1.5
CW-10-10B	M16X1.5	M16X1.5
CW-10-08B	M16X1.5	M14X1.5
CW-12-12B	M18X1.5	M18X1.5
CW-12-08B	M18X1.5	M14X1.5
CW-12-10B	M18X1.5	M16X1.5
CW-15-15B	M22X1.5	M22X1.5
CW-15-10B	M22X1.5	M16X1.5
CW-15-12B	M22X1.5	M18X1.5
CW-22-22B	M30X2	M30X2
CW-22-15B	M30X2	M22X1.5

CCL--公制24° 锥口隔板接管对接接头

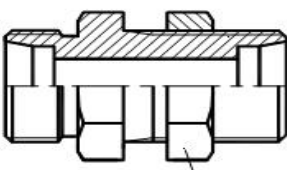

型号	接管螺纹1	接管螺纹2
CCL-06-06B	M12X1.5	M12X1.5
CCL-08-08B	M14X1.5	M14X1.5
CCL-10-10B	M14X1.5	M12X1.5
CCL-12-12B	M16X1.5	M16X1.5
CCL-15-15B	M16X1.5	M14X1.5
CCL-22-22B	M18X1.5	M18X1.5
CCL-28-28B	M18X1.5	M14X1.5



AA--英制60° 锥口管外螺纹BSPB对接接头

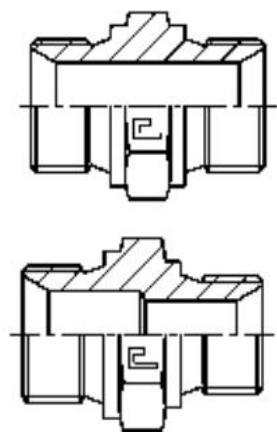

型号	接管螺纹1	接管螺纹2
1/8-1/8-A/A	G1/8"	G1/8"
1/4-1/4-A/A	G1/4"	G1/4"
1/4-1/8-A/A	G1/4"	G1/8"
3/8-3/8-A/A	G3/8"	G3/8"
3/8-1/4-A/A	G3/8"	G1/4"
3/8-1/8-A/A	G3/8"	G1/8"
1/2-1/2-A/A	G1/2"	G1/2"
1/2-1/4-A/A	G1/2"	G1/4"
1/2-3/8-A/A	G1/2"	G3/8"
3/4-3/4-A/A	G3/4"	G3/4"
3/4-3/8-A/A	G3/4"	G3/8"
3/4-1/2-A/A	G3/4"	G1/2"
3/4-1-A/A	G3/4"	G1"
1-1-A/A	G1"	G1"

45AA--英制60° 锥口管外螺纹BSPB对接接头(45° 弯头)

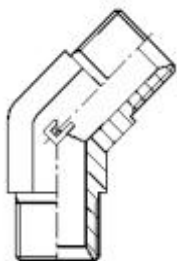

型号	接管螺纹1	接管螺纹2
1/8-1/8-45A/A	G1/8"	G1/8"
1/4-1/4-45A/A	G1/4"	G1/4"
1/4-1/8-45A/A	G1/4"	G1/8"
3/8-3/8-45A/A	G3/8"	G3/8"
3/8-1/4-45A/A	G3/8"	G1/4"
3/8-1/8-45A/A	G3/8"	G1/8"
1/2-1/2-45A/A	G1/2"	G1/2"
1/2-1/4-45A/A	G1/2"	G1/4"
1/2-3/8-45A/A	G1/2"	G3/8"

90AA--英制60° 锥口管外螺纹BSPB对接接头(90° 弯头)

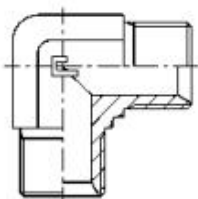

型号	接管螺纹1	接管螺纹2
1/8-1/8-90A/A	G1/8"	G1/8"
1/4-1/4-90A/A	G1/4"	G1/4"
1/4-1/8-90A/A	G1/4"	G1/8"
3/8-3/8-90A/A	G3/8"	G3/8"
3/8-1/4-90A/A	G3/8"	G1/4"
3/8-1/8-90A/A	G3/8"	G1/8"
1/2-1/2-90A/A	G1/2"	G1/2"
1/2-1/4-90A/A	G1/2"	G1/4"
1/2-3/8-90A/A	G1/2"	G3/8"
3/4-3/4-90A/A	G3/4"	G3/4"
3/4-1/2-90A/A	G3/4"	G1/2"



JJ--美制JIC37° 锥口外螺纹对接接头

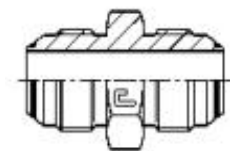

型号	接管螺纹1	接管螺纹2
04-04-JJ	JIC7/16"	JIC7/16"
04-02-JJ	JIC7/16"	JIC5/16"
06-06-JJ	JIC9/16"	JIC9/16"
06-04-JJ	JIC9/16"	JIC7/16"
08-08-JJ	JIC3/4"	JIC3/4"
08-04-JJ	JIC3/4"	JIC7/16"
08-06-JJ	JIC3/4"	JIC9/16"
12-12-JJ	JIC1-1/16	JIC1-1/16"
12-06-JJ	JIC1-1/16	JIC9/16"
12-08-JJ	JIC1-1/16	JIC3/4"

90JJ--美制JIC37° 锥口外螺纹对接接头(90° 弯头)

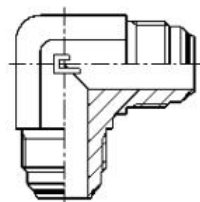

型号	接管螺纹1	接管螺纹2
04-04-90JJ	JIC7/16"	JIC7/16"
04-02-90JJ	JIC7/16"	JIC5/16"
06-06-90JJ	JIC9/16"	JIC9/16"
06-04-90JJ	JIC9/16"	JIC7/16"
08-08-90JJ	JIC3/4"	JIC3/4"
08-04-90JJ	JIC3/4"	JIC7/16"
08-06-90JJ	JIC3/4"	JIC9/16"
12-12-90JJ	JIC1-1/16	JIC1-1/16"
12-06-90JJ	JIC1-1/16	JIC9/16"
12-08-90JJ	JIC1-1/16	JIC3/4"

JJL--美制JIC37° 锥口隔板外螺纹对接接头

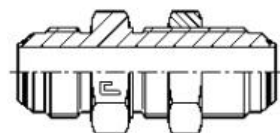

型号	接管螺纹1	接管螺纹2
04-04-JJL	JIC7/16"	JIC7/16"
06-06-JJL	JIC9/16"	JIC9/16"
08-08-JJL	JIC3/4"	JIC3/4"
12-12-JJL	JIC1-1/16	JIC1-1/16"

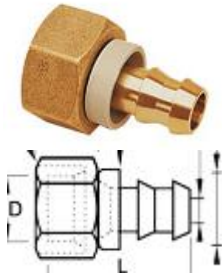
KG0132--公制细牙螺纹旋转螺母软管接头 (适用于Legris公制细牙管接头)

型号	接口螺纹	接管尺寸
KG0132-06-56B	M10X1	DN6-1/4"
KG0132-08-56B	M12X1	DN6-1/4"
KG0132-10-56B	M16X1.5	DN6-1/4"
KG0132-10-60B	M16X1.5	DN10-3/8"
KG0132-14-60B	M20X1.5	DN10-3/8"
KG0132-14-62B	M20X1.5	DN12-1/2"
KG0132-18-62B	M24X1.5	DN12-1/2"
KG0132-22-69B	M30X1.5	DN20-3/4"

KG0133--英制管外螺纹BSPP软管接头(带组合垫圈密封)

型号	接口螺纹	接管尺寸
KG0133-10-56B	G1/8"	DN6-1/4"
KG0133-13-56B	G1/4"	DN6-1/4"
KG0133-13-60B	G1/4"	DN10-3/8"
KG0133-17-60B	G3/8"	DN10-3/8"
KG0133-17-62B	G3/8"	DN12-1/2"
KG0133-21-62B	G1/2"	DN12-1/2"
KG0133-27-69B	G3/4"	DN20-3/4"

KG0134--英制锥外螺纹BSPT软管接头

型号	接口螺纹	接管尺寸
KG0134-10-56B	R1/8"	DN6-1/4"
KG0134-13-56B	R1/4"	DN6-1/4"
KG0134-13-60B	R1/4"	DN10-3/8"
KG0134-17-60B	R3/8"	DN10-3/8"
KG0134-17-62B	R3/8"	DN12-1/2"
KG0134-21-62B	R1/2"	DN12-1/2"
KG0134-27-69B	R3/4"	DN20-3/4"

KG0105--公制细牙螺纹接管/英制锥螺纹BSPT接口接头

型号	接管螺纹1	接口螺纹2
KG0105-06-10B	M10X1	R1/8"
KG0105-06-13B	M10X1	R1/4"
KG0105-06-17B	M10X1	R3/8"
KG0105-08-10B	M12X1	R1/8"
KG0105-08-13B	M12X1	R1/4"
KG0105-08-17B	M12X1	R3/8"
KG0105-10-10B	M16X1.5	R1/8"
KG0105-10-13B	M16X1.5	R1/4"
KG0105-10-17B	M16X1.5	R3/8"
KG0105-10-21B	M16X1.5	R1/2"
KG0105-14-13B	M20X1.5	R1/4"
KG0105-14-17B	M20X1.5	R3/8"
KG0105-14-21B	M20X1.5	R1/2"
KG0105-18-21B	M24X1.5	R1/2"
KG0105-18-27B	M24X1.5	R3/4"
KG0105-22-21B	M30X1.5	R1/2"
KG0105-22-27B	M30X1.5	R3/4"

KG0109--公制细牙螺纹接管/英制锥螺纹BSPT接口接头(90°弯头)

型号	接管螺纹1	接口螺纹2
KG0109-06-10B	M10X1	R1/8"
KG0109-06-13B	M10X1	R1/4"
KG0109-06-17B	M10X1	R3/8"
KG0109-08-10B	M12X1	R1/8"
KG0109-08-13B	M12X1	R1/4"
KG0109-08-17B	M12X1	R3/8"
KG0109-10-10B	M16X1.5	R1/8"
KG0109-10-13B	M16X1.5	R1/4"
KG0109-10-17B	M16X1.5	R3/8"
KG0109-10-21B	M16X1.5	R1/2"
KG0109-14-13B	M20X1.5	R1/4"
KG0109-14-17B	M20X1.5	R3/8"
KG0109-14-21B	M20X1.5	R1/2"
KG0109-18-21B	M24X1.5	R1/2"
KG0109-18-27B	M24X1.5	R3/4"
KG0109-22-21B	M30X1.5	R1/2"
KG0109-22-27B	M30X1.5	R3/4"

KG0143--英制BSPP内管螺纹/英制BSPP内管螺纹直角过渡接头

型号	接口螺纹1	接口螺纹2
KG0143-10-10B	G1/8"	G1/8"
KG0143-13-13B	G1/4"	G1/4"
KG0143-17-17B	G3/8"	G3/8"
KG0143-21-21B	G1/2"	G1/2"
KG0143-27-27B	G3/4"	G3/4"
KG0143-34-43B	G1"	G1"

KG0144--英制BSPP内管螺纹/英制BSPT外锥螺纹直角过渡接头

型号	接口螺纹1	接口螺纹2
KG0144-10-10B	G1/8"	R1/8"
KG0144-13-13B	G1/4"	R1/4"
KG0144-17-17B	G3/8"	R3/8"
KG0144-21-21B	G1/2"	R1/2"
KG0144-27-27B	G3/4"	R3/4"
KG0144-34-34B	G1"	R1"

KG0145--英制BSPP内管螺纹三通过渡接头

型号	接口螺纹1. 2. 3
KG0145-10-10-10B	G1/8"
KG0145-13-13-13B	G1/4"
KG0145-17-17-17B	G3/8"
KG0145-21-21-21B	G1/2"
KG0145-27-27-27B	G3/4"
KG0145-34-34-34B	G1"

KG0146--英制BSPT外螺纹/英制BSPP内螺纹/英制BSPP内螺纹三通接头

型号	接口螺纹1	接口螺纹2. 3
KG0146-10-10-10B	R1/8"	G1/8"
KG0146-13-13-13B	R1/4"	G1/4"
KG0146-17-17-17B	R3/8"	G3/8"
KG0146-21-21-21B	R1/2"	G1/2"
KG0146-27-27-27B	R3/4"	G3/4"

KG0155--英制BSPP内管螺纹/英制BSPP内管螺纹过渡接头

型号	接口螺纹1	接口螺纹2
KG0155-10-10B	G1/8"	G1/8"
KG0155-13-13B	G1/4"	G1/4"
KG0155-17-17B	G3/8"	G3/8"
KG0155-21-21B	G1/2"	G1/2"
KG0155-27-27B	G3/4"	G3/4"
KG0155-34-34B	G1"	G1"

KG0163--英制BSPT外锥螺纹/英制BSPP内管螺纹变径过渡接头

型号	接口螺纹1	接口螺纹2
KG0163-13-10B	R1/4"	G1/8"
KG0163-17-10B	R3/8"	G1/8"
KG0163-17-13B	R3/8"	G1/4"
KG0163-21-13B	R1/2"	G1/4"
KG0163-21-17B	R1/2"	G3/8"
KG0163-27-13B	R3/4"	G1/4"
KG0163-27-17B	R3/4"	G3/8"
KG0163-27-21B	R3/4"	G1/2"

KG0168--英制BSPP管螺纹内外大转小变径过渡接头

型号	接口螺纹1	接口螺纹2
KG0168-13-10B	G1/4"	G1/8"
KG0168-17-10B	G3/8"	G1/8"
KG0168-17-13B	G3/8"	G1/4"
KG0168-21-13B	G1/2"	G1/4"
KG0168-21-17B	G1/2"	G3/8"
KG0168-27-13B	G3/4"	G1/4"
KG0168-27-17B	G3/4"	G3/8"
KG0168-27-21B	G3/4"	G1/2"

KG0169--英制BSPP管螺纹内外小转大变径过渡接头

型号	接口螺纹1	接口螺纹2
KG0169-10-13B	G1/4"	G1/8"
KG0169-10-17B	G3/8"	G1/8"
KG0169-13-17B	G3/8"	G1/4"
KG0169-13-21B	G1/2"	G1/4"
KG0169-17-21B	G1/2"	G3/8"
KG0169-17-27B	G3/4"	G1/4"
KG0169-21-27B	G3/4"	G3/8"

KG0929--英制BSPT外螺纹三件式转接头

型号	接口螺纹1	接口螺纹2
KG0929-10-10B	R1/8"	R1/8"
KG0929-13-13B	R1/4"	R1/4"
KG0929-17-17B	R3/8"	R3/8"
KG0929-21-21B	R1/2"	R1/2"
KG0929-27-27B	R3/4"	R3/4"

KG0205--英制BSPT锥螺纹内六角堵头



型号	接口螺纹1
KG0205-10-00B	R1/8"
KG0205-13-00B	R1/4"
KG0205-17-00B	R3/8"
KG0205-21-00B	R1/2"
KG0205-27-00B	R3/4"
KG0205-34-00B	R1"

KG0220--英制BSPP管螺纹外六角堵头

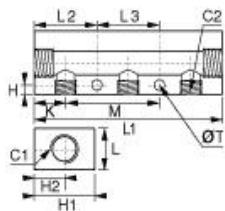

型号	接口螺纹1
KG0220-10-00B	G1/8"
KG0220-13-00B	G1/4"
KG0220-17-00B	G3/8"
KG0220-21-00B	G1/2"
KG0220-27-00B	G3/4"
KG0220-34-00B	G1"

KG-0225--英制BSPP/公制M管螺纹内六角堵头（带ED胶垫密封）

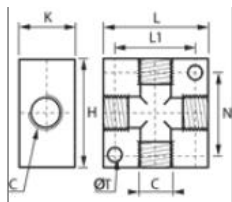

型号	接口螺纹1
KG0225-10-00EDB	G1/8"
KG0225-13-00EDB	G1/4"
KG0225-17-00EDB	G3/8"
KG0225-21-00EDB	G1/2"
KG0225-27-00EDB	G3/4"
KG0225-34-00EDB	G1"
KG0225-M10-00EDB	M10X1
KG0225-M12-00EDB	M12X1.5
KG0225-M14-00EDB	M14X1.5
KG0225-M16-00EDB	M16X1.5
KG0225-M18-00EDB	M18X1.5
KG0225-M20-00EDB	M20X1.5
KG0225-M22-00EDB	M22X1.5
KG0225-M26-00EDB	M26X1.6
KG0225-M27-00EDB	M27X2
KG0225-M33-00EDB	M33X2

KG3311—气路分配座内螺纹, BSPP直螺纹

型号	接口螺纹1	接口螺纹2
KG3311-10-13-02	G1/4"	G1/8"X2
KG3311-10-13-03	G1/4"	G1/8"X3
KG3311-10-13-04	G1/4"	G1/8"X4
KG3311-10-13-05	G1/4"	G1/8"X5
KG3311-10-13-06	G1/4"	G1/8"X6
KG3311-13-17-02	G3/8"	G1/4"X2
KG3311-13-17-03	G3/8"	G1/4"X3
KG3311-13-17-04	G3/8"	G1/4"X4
KG3311-13-17-05	G3/8"	G1/4"X5
KG3311-13-17-06	G3/8"	G1/4"X6

KG3312—气路分配座四通内螺纹, BSPP直螺纹

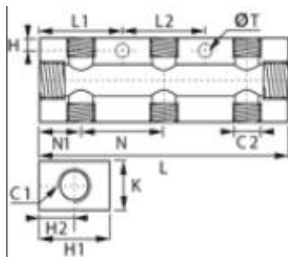
型号	接口螺纹1
KG3312-10-00	G1/8"X4
KG3312-13-00	G1/4"X4
KG3312-17-00	G3/8"X4
KG3312-21-00	G1/2"X4

KG3313—气路分配座双通内螺纹, BSPP直螺纹

型号	接口螺纹1	接口螺纹2
KG3313-10-13-02	G1/4"	G1/8"X2
KG3313-10-13-03	G1/4"	G1/8"X3
KG3313-10-13-04	G1/4"	G1/8"X4
KG3313-10-13-05	G1/4"	G1/8"X5
KG3313-13-17-02	G3/8"	G1/4"X2
KG3313-13-17-03	G3/8"	G1/4"X3
KG3313-13-17-04	G3/8"	G1/4"X4
KG3313-13-17-05	G3/8"	G1/4"X5
KG3313-13-21-03	G1/2"	G1/4"X3
KG3313-13-21-04	G1/2"	G1/4"X4
KG3313-13-21-05	G1/2"	G1/4"X5



经销进口水气软管 PARKER--801系列



软管构造：合成橡胶内胶层，一层纤维增强层，合成橡胶外胶层。

应用：车间空气系统，气动系统及通用工业维修和汽车工业用空气，水，润滑油及防冻液。也用于真空状态，但不推荐用于压缩空气刹车系统，可燃气体及液压系统或有剧烈脉动状态，不适用于可控硅冷却

温度范围：-40° C/+100° C

适用接头：KGPush-Lok铜接头

提供多种颜色：黑-BLK, 蓝-BLU, 红-RED. 另外可以供绿, 灰及黄色等

型号	内径	压力
801-4-BLK-RL	DN6-1/4"	300PSI
801-4-BLU-RL	DN6-1/4"	300PSI
801-4-RED-RL	DN6-1/4"	300PSI
801-6-BLK-RL	DN10-3/8"	300PSI
801-6-BLU-RL	DN10-3/8"	300PSI
801-6-RED-RL	DN10-3/8"	300PSI
801-8-BLK-RL	DN12-1/2"	300PSI
801-8-BLU-RL	DN12-1/2"	300PSI
801-8-RED-RL	DN12-1/2"	300PSI
801-12-BLK-RL	DN20-3/4"	300PSI
801-12-BLU-RL	DN20-3/4"	300PSI
801-12-RED-RL	DN20-3/4"	300PSI

Goodyear-Horizon200. 250. 300系列 多用途水气软管（普通管）

HORIZON®



应用：经济型空气及水软管，广泛应用于工业，建筑，农业等行业，工作压力有200PSI, 250PSI, 300PSI
二种

内胶层：Versigard合成耐油橡胶

外胶层：Versigard彩色合成胶

可提供黑, 红, 黄, 绿, 蓝等色

增强层：合成纤维缠绕层

适用温度：-40° C/+88° C

适用接头：KGPush-Lok铜接头

型号	内径	压力
Horizon200-04	DN6-1/4"	200PSI
Horizon250-04	DN6-1/4"	250PSI
Horizon300-04	DN6-1/4"	300PSI
Horizon200-06	DN10-3/8"	200PSI
Horizon250-06	DN10-3/8"	250PSI
Horizon300-06	DN10-3/8"	300PSI
Horizon200-08	DN12-1/2"	200PSI
Horizon250-08	DN12-1/2"	250PSI
Horizon300-08	DN12-1/2"	300PSI
Horizon200-12	DN20-3/4"	200PSI
Horizon250-12	DN20-3/4"	250PSI
Horizon300-12	DN20-3/4"	300PSI



非石棉防火耐热制品

防火套管

简介

防火套管以高膨松性玻璃纤维之套管所制成，可依需求提供多种颜色选择。



以高膨松性玻璃纤维之套管所制成，并覆以厚实的氧化铁红硅胶，防火套管能阻挡熔铁喷溅，且不受高温和火焰所损坏，这些性质使其适用于保护恶劣环境下的软管、缆线和管路。防火套管可连续暴露于500° F (260° C)的高温中而不受损坏，高达2000° F (1090° C)的温度下可承受15-20分钟，3000° F (1650° C)的温度下则可承受15-30秒。防火套管尺寸齐全，最大直径达5英寸(127毫米)，且拥有绝佳的延展系数，极适合用于包覆软管和缆线。防火套管的阻绝特性除了能够有效避免人员遭受高热管线的烧烫伤害，更能大幅节约热能源流失的成本。防火套管备有一般工业品级和航天工业品级可供选择。可依需求提供多种颜色选择。

防火套管可供应尺寸为直径1/2英寸(15mm)至直径4-1/2英寸(115mm)。

FR-F15——**FR-F115**



防火护毯为一种耐高温纤维产品，设计上可用于阻挡焊接喷溅物以及阻绝辐射热与火焰。防火护毯96oz是防火护毯32oz的极耐用改良款式。设计上可用于阻挡熔融钢渣，就如同“水珠滑落鸭背”般的容易。



FR-32oz



FR-96oz



KAGO铜接头系列产品将给您的设备带来安全可靠 经济高效地管路连接



Exclusively designed to be connected to push-on hose (see Tubing and Hoses section), Legris quick-acting barbed fittings are perfectly adapted to modern requirements of industry, such as automation.

Connection is quick and easy:

- no grease or oil is needed to lubricate the tube and no preparation time is required. Safety for both installer and user is safeguarded since the tube when pushed onto the fitting butts against and beneath the grey collar visually confirming correct connection.
- to disconnect, cut the tube with a knife on the barbed side of the fitting.



correct connection =
the tube is pushed on to the fitting to butt against and beneath the collar

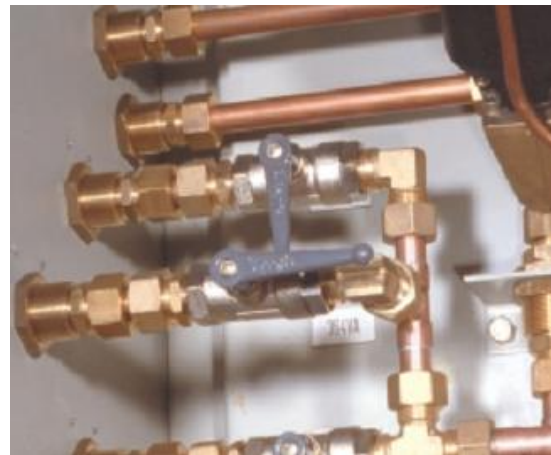
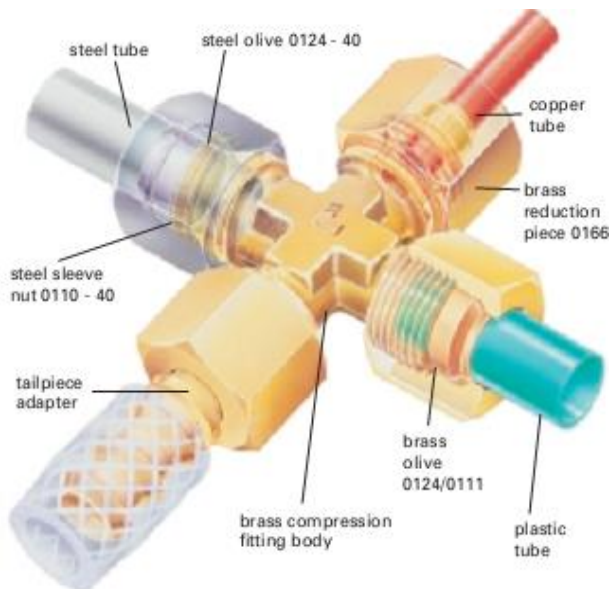

上海仰贡工程科技有限公司